

THIS DRAWING IS UNPUBLISHED. RELEASED FOR PUBLICATION 20  
 © COPYRIGHT 20 BY TYCO ELECTRONICS CORPORATION. ALL RIGHTS RESERVED.

LOC	DIST	REVISIONS					
CE	00	P	LTR	DESCRIPTION	DATE	DWN	APVD
		B		REVISE PER ECR-08-000080	09JAN2008	BB	LS
		C		REVISE PER ECR-08-019177	31JUL2008	BB	LS

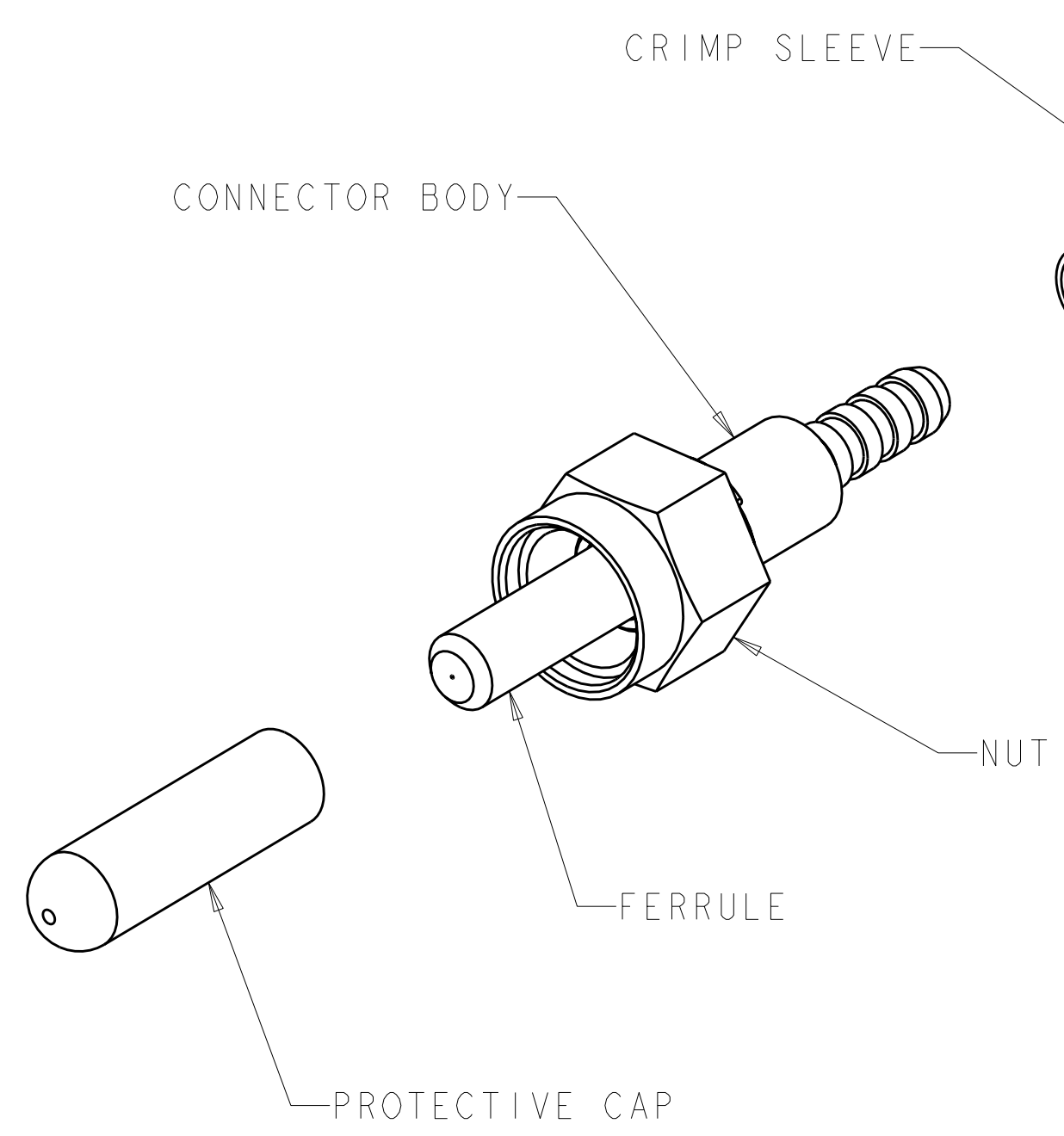
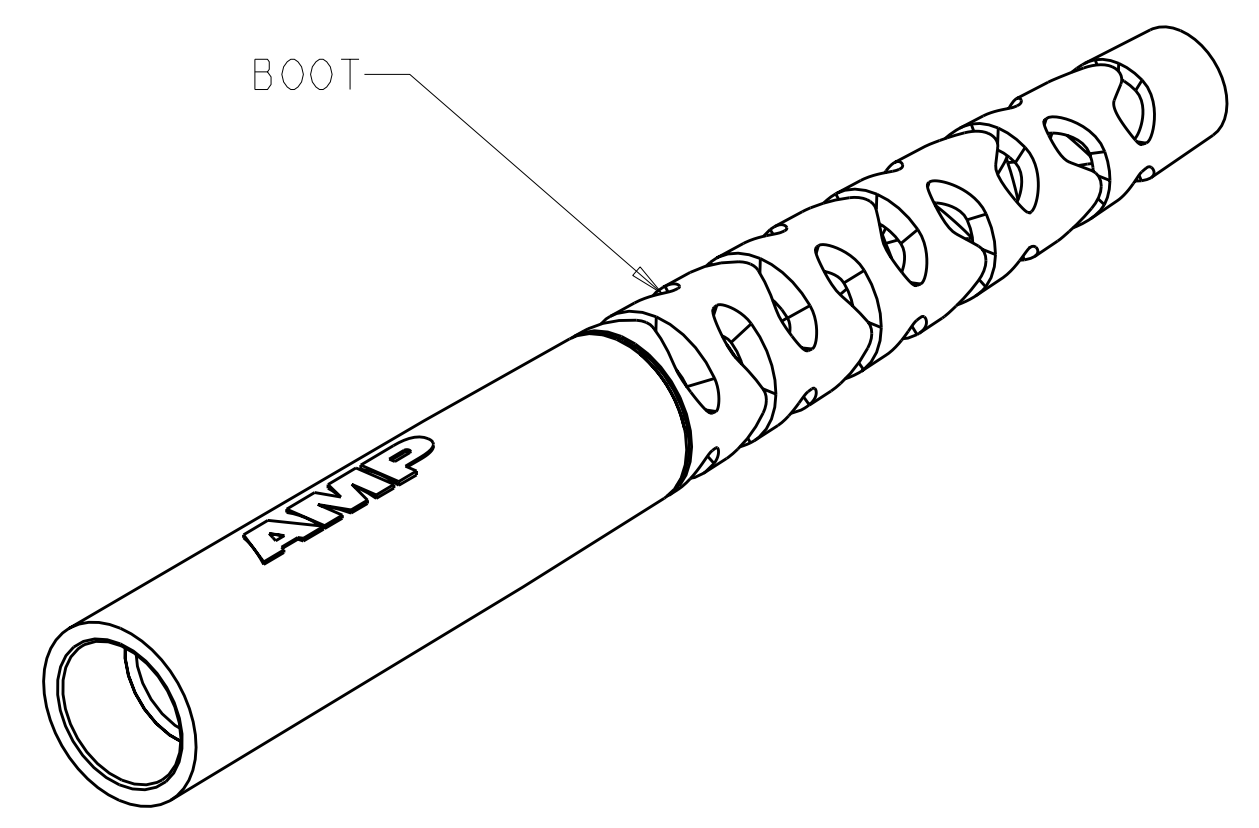
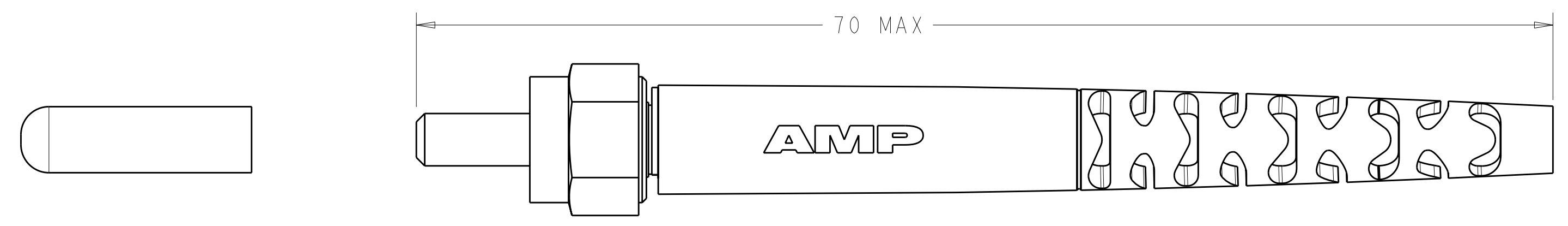

△ MATERIAL:  
 CONNECTOR ASSEMBLY:  
 FERRULE: STAINLESS STEEL  
 REAR BODY: BRASS, NICKEL PLATED  
 COUPLING NUT: BRASS, NICKEL PLATED  
 CRIMP EYELET: BRASS, NICKEL PLATED  
 BOOT: POLYOLEFIN ELASTOMER, COLOR: BLACK\*  
 PROTECTIVE CAP: VINYL, COLOR: RED  
 \*UL94 V-0 RATED AT QUALIFYING THICKNESS.

2. COUPLING NUT NORMAL TIGHTENING TORQUE RANGE IS 7.0 TO 10.0 in-lbf. DO NOT EXCEED 20 in-lbf.

△ 3 CRIMP SLEEVE AND BOOT NOT SUPPLIED.

△ 3	1.48mm	4-5504566-3
	635um	4-5504566-2
	.042 in	3-5504566-1
	.039 in	3-5504566-0
	641um	2-5504566-8
	336um	1-5504566-4
	231um	5504566-7
	140um	5504566-2
	125um	5504566-1
	FIBER HOLE SIZE	PART NUMBER

THIS DRAWING IS A CONTROLLED DOCUMENT FOR TYCO ELECTRONICS CORPORATION. IT IS SUBJECT TO CHANGE AND THE CONTROLLING ENGINEERING ORGANIZATION SHOULD BE CONTACTED FOR THE LATEST REVISION.		DWN B. BRIGGS 16 JUN 2005	Tyco Electronics Harrisburg, PA 17105-3608	
DIMENSIONS: mm		CHK L. SAUERWEIN 16 JUN 2005	NAME CONNECTOR KIT, SMA 905, STAINLESS STEEL FRONT BODY, BRASS REAR BODY, 3.1mm CABLE	
TOLERANCES UNLESS OTHERWISE SPECIFIED: 0 PLC ± 1 PLC ± 2 PLC ± 3 PLC ± 4 PLC ± ANGLES ± FINISH		APVD S. BUCHTER 16 JUN 2005	SIZE A200779	
MATERIAL △ 1 -		PRODUCT SPEC - APPLICATION SPEC - WEIGHT -	DRAWING NO C-5504566	
		CUSTOMER DRAWING		RESTRICTED TO -
		SCALE 4:1		SHEET 1 OF 1 REV C